

**TECHNICAL BULLETIN**

**RECONFIGURATION OF CLICK-FIT FLUE OUTLET**

The 'Click-fit' flue outlet on the appliance can be easily reconfigured to enable a standard HE flue terminal\* to be connected to the appliance, or if/when the rear flue terminal\*\* is to be utilised.

To reconfigure:

- Locate and remove the 3 retaining screws that secure the white 'Click-fit' flange to the appliance (see below); retain the screws as they'll be required later.
- Remove the large black sealing gasket located below the 'Click-fit' flange and discard.
- **Do not remove** the black 60mm 'O' ring seal from the inner 60mm pipe
- Refit the 3 retaining screws.

The flue outlet is now ready to be used with the standard HE flue terminal\* or can be closed off if the rear flue terminal\*\* is being utilised.

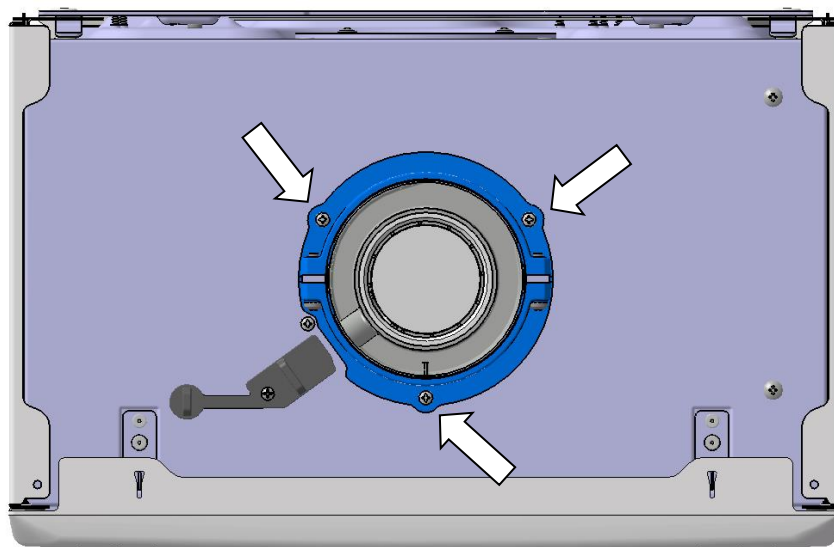

**\*Standard HE Flue Terminals**

Terminal Type	Code
Horizontal flue terminal	29450120 or 20132063
Telescopic flue terminal	29450121 or 20131981
Vertical terminal	29450122 or 20131983

**\*\*Rear Flue Terminal**

Terminal Type	Code
Rear flue terminal	29450133 or 20132064

**NOTE**

These instructions should be read in conjunction with the appliance installation instructions and the instructions that are supplied with the individual flue accessories.